

MATCHLINE: SEE SHEET IR-3

MATCHLINE: SEE BELOW LEFT

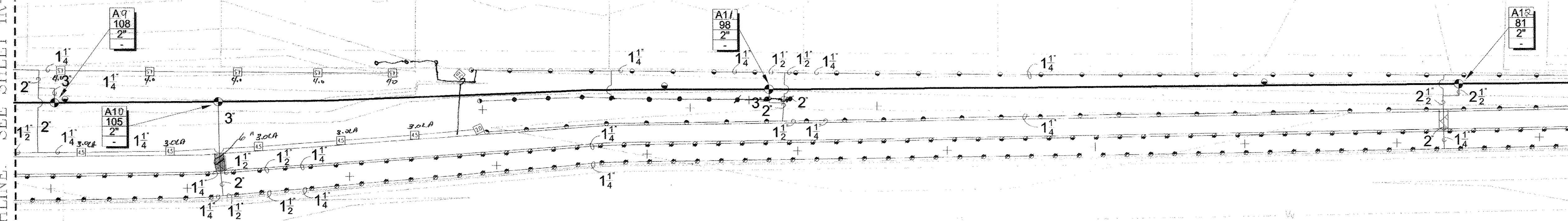

MATCHLINE: SEE ABOVE RIGHT

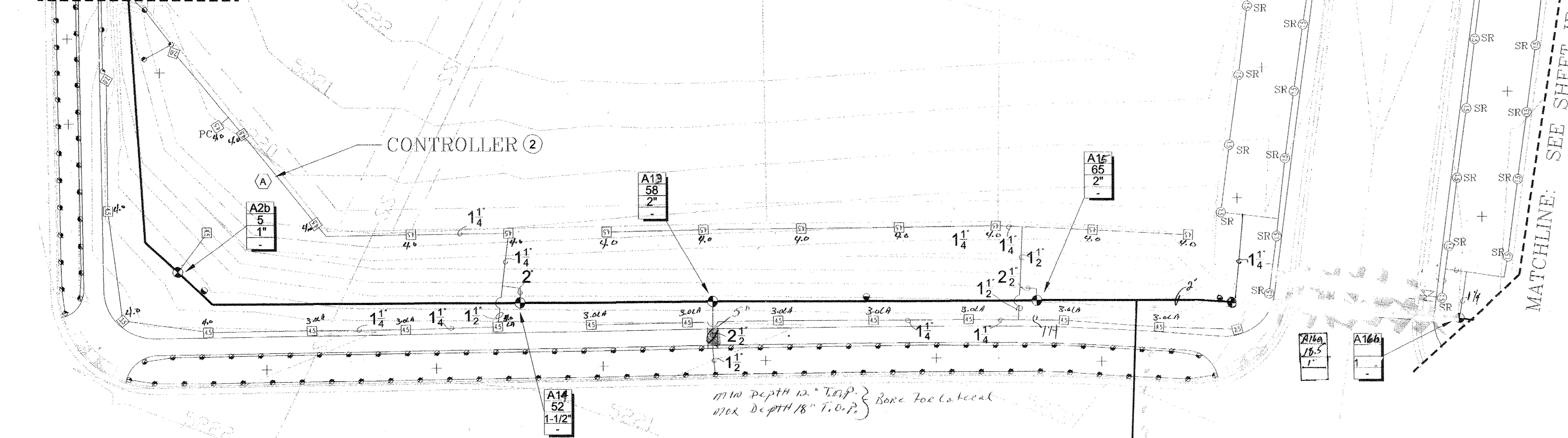

INSTALLATION GENERAL NOTES

- READ THOROUGHLY AND BECOME FAMILIAR WITH THE SPECIFICATIONS AND INSTALLATION DETAILS FOR THIS AND RELATED WORK PRIOR TO CONSTRUCTION.
- COORDINATE UTILITY LOCATES ("CALL BEFORE YOU DIG") OF UNDERGROUND UTILITIES PRIOR TO CONSTRUCTION.
- DO NOT PROCEED WITH THE INSTALLATION OF THE IRRIGATION SYSTEM WHEN IT IS OBVIOUS IN THE FIELD THAT OBSTRUCTIONS OR GRADE DIFFERENCES EXIST THAT MIGHT NOT HAVE BEEN CONSIDERED IN THE ENGINEERING. IF DISCREPANCIES IN CONSTRUCTION DETAILS, LEGEND, NOTES, OR SPECIFICATIONS ARE DISCOVERED, BRING ALL SUCH OBSTRUCTIONS OR DISCREPANCIES TO THE ATTENTION OF THE OWNER'S REPRESENTATIVE.
- THE DRAWINGS ARE DIAGRAMMATIC. THEREFORE, THE FOLLOWING SHOULD BE NOTED:
 - ALTHOUGH IRRIGATION COMPONENTS MAY BE SHOWN OUTSIDE PLANTING AREAS FOR CLARITY, INSTALL IRRIGATION PIPE AND WIRING IN LANDSCAPED AREAS WHENEVER POSSIBLE.
 - TREE AND SHRUB LOCATIONS AS SHOWN ON LANDSCAPE PLANS TAKE PRECEDENCE OVER IRRIGATION EQUIPMENT LOCATIONS. AVOID CONFLICTS BETWEEN THE IRRIGATION SYSTEM, PLANTING MATERIALS, AND ARCHITECTURAL FEATURES.
 - USE ONLY STANDARD TEES AND ELBOW FITTINGS. USE OF CROSS TYPE FITTINGS IS NOT ALLOWED.
- PROVIDE THE FOLLOWING COMPONENTS TO THE OWNER PRIOR TO THE COMPLETION OF THE PROJECT:
 - TWO (2) OPERATING KEYS FOR EACH TYPE OF MANUALLY OPERATED VALVES.
 - TWO (2) OF EACH SERVICING WRENCH OR TOOL NEEDED FOR COMPLETE ACCESS, ADJUSTMENT, AND REPAIR OF ALL ROTARY SPRINKLERS.
- SELECT NOZZLES FOR SPRAY AND ROTARY SPRINKLERS WITH ARCS WHICH PROVIDE COMPLETE AND ADEQUATE COVERAGE WITH MINIMUM OVERSPRAY FOR THE SITE CONDITIONS. CAREFULLY ADJUST THE RADIUS OF THROW AND ARC OF COVERAGE OF EACH ROTARY SPRINKLER TO PROVIDE THE BEST PERFORMANCE.
- THE IRRIGATION CONTRACTOR IS RESPONSIBLE FOR THE INSTALLATION OF IRRIGATION SLEEVING. SLEEVES ARE REQUIRED FOR BOTH PIPING AND ELECTRICAL WIRING AT EACH HARDSCAPE CROSSING. COORDINATE INSTALLATION OF SLEEVING WITH OTHER TRADES. ANY PIPE OR WIRE WHICH PASSES BENEATH EXISTING HARDSCAPE WHERE SLEEVING WAS NOT INSTALLED WILL REQUIRE HORIZONTAL BORING BY THE IRRIGATION CONTRACTOR.
- INSTALL ALL ELECTRICAL POWER TO THE IRRIGATION CONTROL SYSTEM IN ACCORDANCE WITH THE NATIONAL ELECTRIC CODE AND ALL APPLICABLE LOCAL ELECTRIC UTILITY CODES.
- THE FOLLOWING SHOULD BE NOTED REGARDING PIPE SIZING: IF A SECTION OF UNSIZED PIPE IS LOCATED BETWEEN THE IDENTICALLY SIZED SECTIONS, THE UNSIZED PIPE IS THE SAME NOMINAL SIZE AS THE TWO SIZED SECTIONS. THE UNSIZED PIPE SHOULD NOT BE CONFUSED WITH THE DEFAULT PIPE SIZE NOTED IN THE LEGEND.
- INSTALL TWO (2) #14 AWG CONTROL WIRES FROM CONTROLLER LOCATION TO EACH DEAD-END OF MAINLINE FOR USE AS SPARES IN CASE OF CONTROL WIRE FAILURE. COIL 3 FEET OF WIRE IN VALVE BOX.
- REFER TO PROPOSED MAINLINE AND SLEEVING PLAN, DESIGNED BY HYDROSYSTEMS, FOR MORE PUMP STATION INFORMATION.
- PRIOR TO CONSTRUCTION OF PHASE 3, CONTROLLERS "A" AND "B" (PHASE 2) SHALL NOT OPERATE SIMULTANEOUSLY.

IRRIGATION LEGEND

- SLEEVES: CLASS 200 PVC
- EXISTING IRRIGATION MAINLINE PIPE: CLASS 200 PVC (4-INCH UNLESS OTHERWISE NOTED)
- - - CONTROL WIRE IN 1-INCH WIRE CONDUIT (MARK WITH WARNING TAPE)
- LATERAL PIPE TO SPRINKLERS: CLASS 200 PVC (1-INCH SIZE UNLESS OTHERWISE INDICATED)
- LATERAL PIPE TO EMITTERS: UV RADIATION RESISTANT POLYETHYLENE (3/4-INCH SIZE, ROUTING IS DIAGRAMMATIC)
- UNCONNECTED PIPE CROSSING
- POINT-OF-CONNECTION (P.O.C.) ASSEMBLY
- IRRIGATION PUMP STATION
- ISOLATION GATE VALVE ASSEMBLY
- QUICK COUPLING VALVE ASSEMBLY
- REMOTE CONTROL VALVE ASSEMBLY FOR SPRINKLER LATERALS
- ● ● POP-UP SPRAY SPRINKLER: RAIN BIRD 1800-SAM-PR3 W/5 SERIES NOZZLE
PRESSURE: 30 PSI RADIUS: 15 FEET
FLOW (GPM): Q - 0.33' H - 1.05 F - 3.70
- ● ● POP-UP SPRAY SPRINKLER: RAIN BIRD 1800-SAM-PR3 W/10 SERIES NOZZLE
PRESSURE: 30 PSI RADIUS: 10 FEET
FLOW (GPM): Q - 0.33' H - 0.79 F - 1.51
- ⊗ POP-UP ROTOR SPRINKLER: HUNTER 1-20 ADS
PRESSURE: 50 PSI
- ⊗ 2.0LA NOZZLE RADIUS: 28' FLOW: 2.1 GPM
- ⊗ 2.5LA NOZZLE RADIUS: 33' FLOW: 2.8 GPM
- ⊗ 3.5LA NOZZLE RADIUS: 39' FLOW: 3.5 GPM
- ⊗ 4.5LA NOZZLE RADIUS: 37' FLOW: 4.4 GPM
- ⊗ 10SR NOZZLE RADIUS: 18' FLOW: 10 GPM
- ⊗ 15SR NOZZLE RADIUS: 25' FLOW: 15 GPM
- ⊗ 2.0 NOZZLE RADIUS: 38' FLOW: 2.0 GPM
- ⊗ 3.0 NOZZLE RADIUS: 40' FLOW: 2.1 GPM
- ⊗ 3.5 NOZZLE RADIUS: 42' FLOW: 2.4 GPM
- ⊗ 4.0 NOZZLE RADIUS: 43' FLOW: 4.2 GPM
- ⊗ 6.0 NOZZLE RADIUS: 43' FLOW: 5.5 GPM
- ⊗ 8.0 NOZZLE RADIUS: 45' FLOW: 7.6 GPM
- PC = PART CIRCLE SR = SHORT RADIUS NOZZLES
- ⊗ REMOTE CONTROL VALVE ASSEMBLY FOR DRIFP LATERALS
- ⊗ FLUSH GAP ASSEMBLY
- ⊗ IRRIGATION CONTROLLER UNIT:
CONTROLLER A: IRRITROL MC-37PLUS-B: 31 STA. USED
CONTROLLER B: IRRITROL MC-29PLUS-B: 32 STA. USED
CONTROLLER C: IRRITROL MC-28PLUS-B: 8 STA. USED
- ⊗ INDICATES CONTROLLER AND STATION NUMBER
- ⊗ INDICATES LATERAL DISCHARGE (GPM)
- ⊗ INDICATES VALVE SIZE (INCHES)
- ⊗ INDICATES SPRINKLER RISER POP-UP HEIGHT (4-INCH UNLESS OTHERWISE NOTED)
- ⊗ APPROXIMATE TREE LOCATIONS

CONSTRUCTION NOTES

- CONTRACTOR SHALL STUBOUT 1-INCH MAINLINE PIPE FOR FUTURE USE BY THE HOMEOWNER. INSTALL PVC BALL VALVE IN 10" ROUND VALVE BOX, PER DETAILS, AS INDICATED ON DRAWINGS.
- PEDESTAL MOUNT THE IRRIGATION CONTROLLER AT THE APPROXIMATE LOCATION SHOWN. COORDINATE ELECTRICAL POWER TO THE CONTROLLER WITH THE OWNER'S REPRESENTATIVE. CARE SHOULD BE TAKEN TO INSTALL THE IRRIGATION CONTROLLER IN A LOCATION THAT IS ACCESSIBLE FOR MAINTENANCE BEHIND PLANT MATERIAL. FINAL LOCATION TO BE APPROVED BY OWNER'S REPRESENTATIVE.

Phase 1 Mainline ends at Gate Valves on page 6012

IRRIGATION PLAN

BUFFALO CREEK SUBDIVISION

WELLINGTON, COLORADO
DATE: MARCH 24, 2024
REVISIONS:

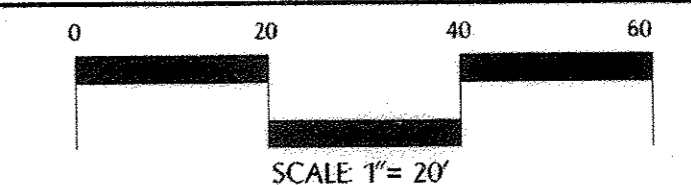

SCALE 1" = 20'
SHEET 4 OF 12

HINES IRRIGATION CONSULTANTS, INC.
SYSTEM DESIGN AND WATER MANAGEMENT SERVICES
344 E. FOOTBALLS PARKWAY, SUITE 1-W
FORT COLLINS, COLORADO 80525
Telephone: 970.204.9245
Fax: 970.226.4662

PINECREST
PLANNING AND DESIGN
4225 Westshore Way • Fort Collins, CO 80525
(970) 226-1655 • Fax (970) 226-1635